



# CASE STUDY

**F51 SKATEPARK**  
Metalfab Engineering Ltd

## INTRODUCTION

The F51 Sports Park in Folkestone is the world's first multi-storey skatepark and recipient of the RIBA South East Building of the Year award. The unique concept for this building was designed by Holloway Studio and built in collaboration with ParkerSteel and Metalfab Engineering Ltd, who worked together closely to overcome the engineering challenges presented by using high-quality materials and expert fabrication to bring the one-of-a-kind vision to life.



## Materials

350t of Mild Steel  
5+ pallets of fixings



## Processes

Laser, Plasma, Plate Driller, Tube  
Laser, Saw Drills and Shotblaster



## Requirements

1000+ Mitre Cuts  
5000+ Holes  
60t of Plate Girders



[www.parkersteel.co.uk](http://www.parkersteel.co.uk)



01227 783333



[sales@parkersteel.co.uk](mailto:sales@parkersteel.co.uk)

## A BEACON OF HOPE

Situated in one of Folkestone's most deprived areas, F51 Sports Park has a greater purpose beyond its aesthetic and architectural appeal. This inspiring community building was funded by philanthropist Roger de Haan and serves as a safe space for young people to learn and thrive through sport and create a positive impact on the local community. A variety of sports facilities are available in this building, including multiple skating floors, a climbing wall, boxing club and communal areas for socialising.

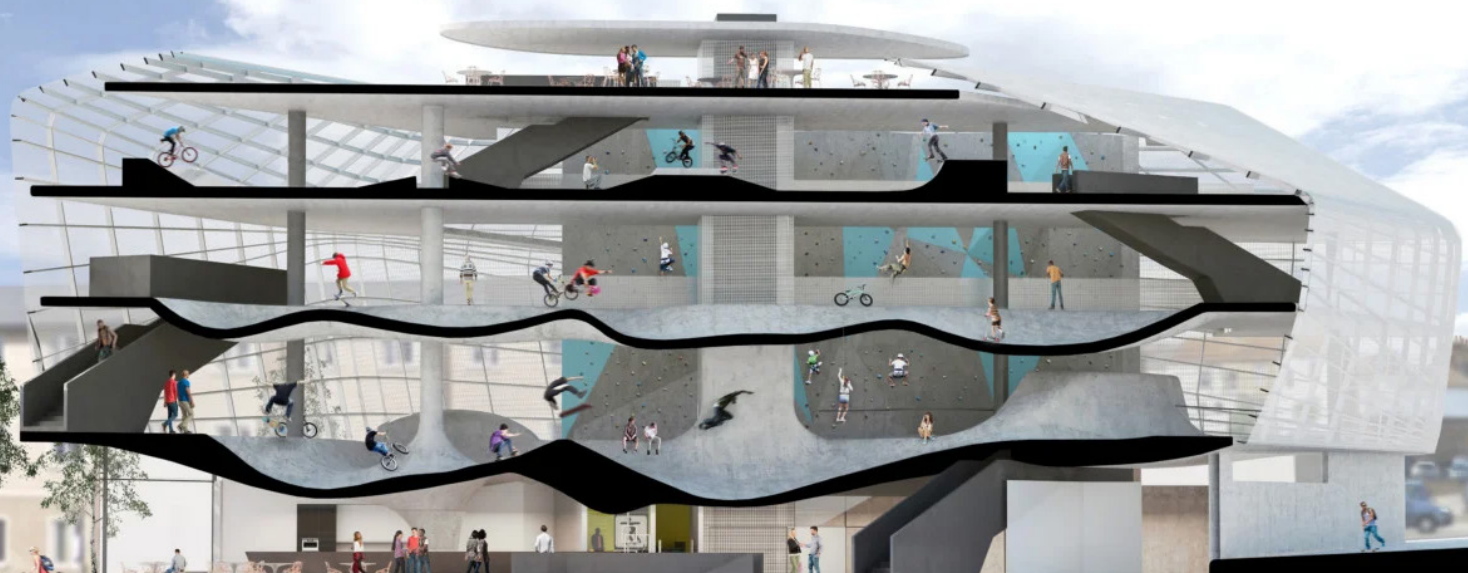

## CONCLUSION

This immensely successful collaboration between ParkerSteel and MetalFab Engineering has created a lasting impact on Folkestone's landscape. The F51 Sports Park stands as a symbol of innovation and community engagement and demonstrates the combined expertise of both companies in achieving the best final outcome.

Image Credits: Hufton & Crow and Hollaway Studio

## COLLABORATION WITH METALFAB ENGINEERING

As the steel supplier for this project, ParkerSteel provided 350 tonnes of high-quality heavy plates and fixings for F51 Sports Park's construction. Featuring over 1,000 mitre cuts and 5,000 individual holes, the material was shotblasted, drilled and cut on-site using plasma and laser machines before being delivered to MetalFab Engineering, who used their expertise and craftsmanship to fabricate and install the intricate steel structures.

Despite the tight deadlines involved, ParkerSteel's exceptional delivery service ensured that all the material arrived on time and in good condition to facilitate the rest of the job.



 [www.parkersteel.co.uk](http://www.parkersteel.co.uk)

 01227 783333

 [sales@parkersteel.co.uk](mailto:sales@parkersteel.co.uk)